



Canfield Gardens NW6





Canfield Gardens, NW6
£475,000
Leasehold

- 2 double bedroom, 2 bathroom apartment
- Private balcony
- Both double bedrooms with en-suite
- 623 sq ft / 57.8 sq m
- Guest WC
- 18'5 open plan kitchen/reception
- 1 minute walk to Finchley Road station (Jubilee and Metropolitan lines)
- Offered chain free



Belsize Park/Hampstead
 208 Haverstock Hill
 NW3 2AG
 Sales 020 7431 1234
 Lettings 020 7431 3104
nw3@parkheath.com

South/West Hampstead
 192 West End Lane
 NW6 1SG
 Sales & Lettings
 Tel 020 7794 7111
192@parkheath.com

Kensal Rise
 54-56 Chamberlayne Rd
 NW10 3JH
 Tel 020 8960 4845
kensal@parkheath.com

Property Management
 192 West End Lane
 NW6 1SG
 020 7433 6174
pm@parkheath.com

Parkheath
Sold on Service

Camden Tax band D

www.parkheath.com

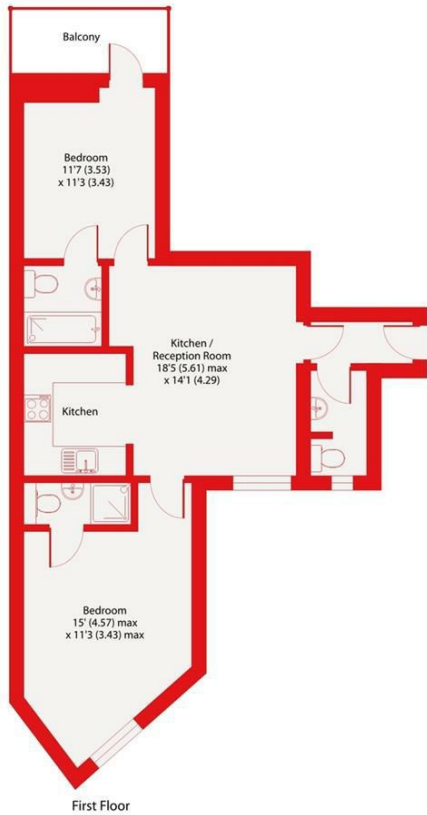

Canfield Gardens, NW6
 Approximate Area = 623 sq ft / 57.8 sq m
 For identification only - Not to scale



Floor plan produced in accordance with RICS Property Measurement Standards incorporating
 International Property Measurement Standards (IPMS2 Residential). © richcom 2024.
 Produced for Kinleigh Folkard & Hayward. REF: 1089271

Kinleigh Folkard & Hayward

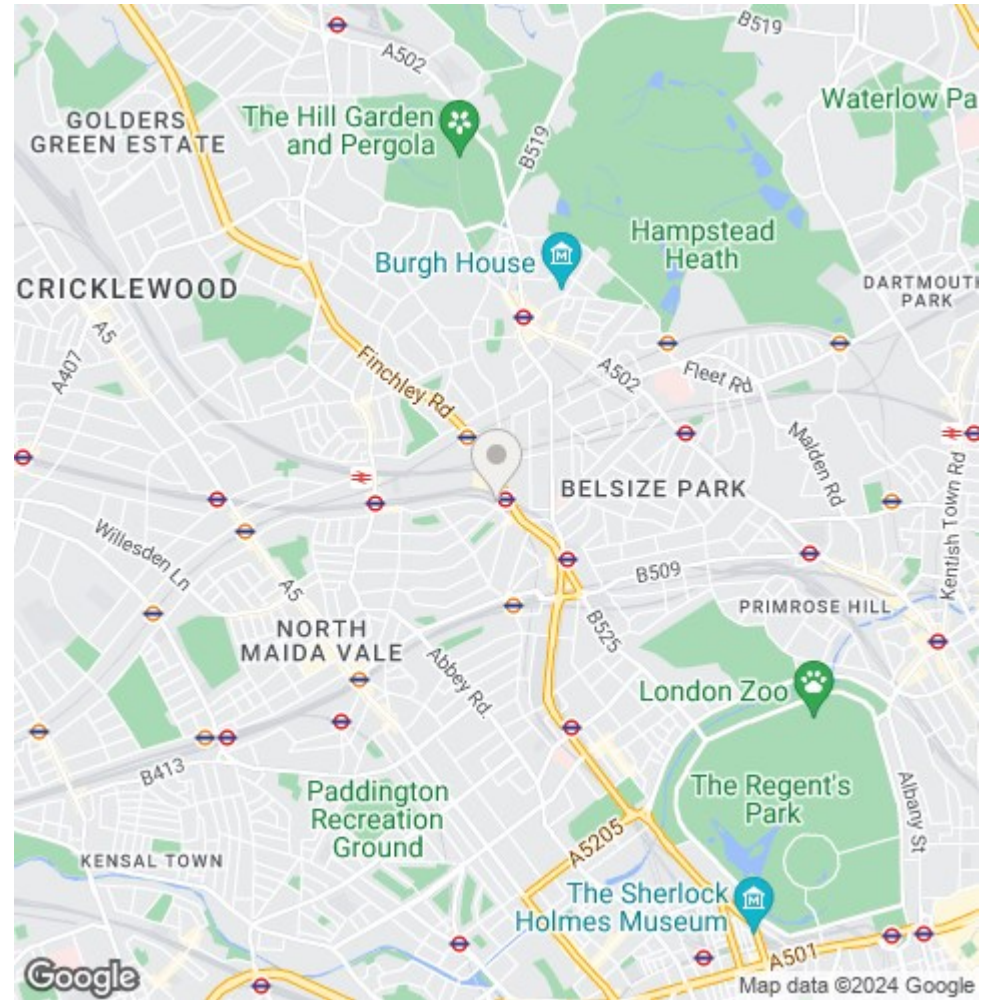

The particulars do not constitute part of an offer or contract. The particulars, including text, photographs and plans, are for the guidance only of prospective purchasers/tenants and must not be relied upon as statements of fact. The descriptions provided therein represent the opinion of the author and whilst given in good faith should not be construed as statements of fact. Nothing in these particulars shall be deemed a statement that the property is in good condition or otherwise or that any services or facilities are in good working order. All measurements are approximate